

ROUND38 - WITHOUT RETURNS

Account No.	Account Name:	Contact No.
Town/Branch:	A/C Postcode:	Order Ref.
Track Colour: <input type="radio"/> White <input type="radio"/> Black <input type="radio"/> Chalk <input type="radio"/> Bronze <input type="radio"/> Oyster <input type="radio"/> Ash <input type="radio"/> Nimbus <input type="radio"/> Slate		
Finial Style: <input type="radio"/> End Cap <input type="radio"/> Ball		Measuring Bay Windows: Identify the type of bay window you have, the measurements as indicated of the actual wall. We will work out the angles and lengths required allowing for bracket standoff etc. (alternatively write in the actual angles on the appropriate diagram if you know them) All tracks are supplied in at least 2 parts and oversized to be trimmed on site.
Bracket Options: <input type="radio"/> Adjustable 75mm-110mm <input type="radio"/> Adjustable 110mm-150mm		
Glider Options <input type="radio"/> Standard Gliders <input type="radio"/> Surf 60 - Single Curtain <input type="radio"/> Surf 80 - Single Curtain <input type="radio"/> Surf 60 - Pair of Curtains <input type="radio"/> Surf 80 - Pair of Curtains		

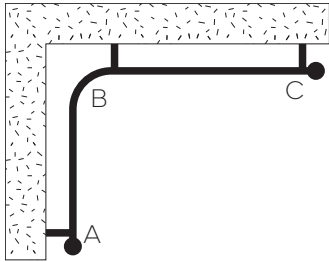

SINGLE BEND BAY Dimensions in... Millimetres Inches

A - B	B - C
A - C	OR Angle Required:

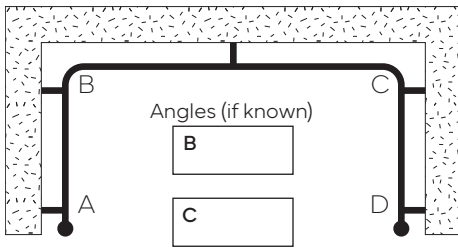

TWO BEND BAY Dimensions in... Millimetres Inches

A - B	B - C
C - D	A - D

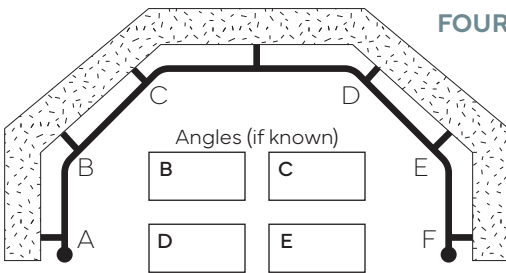

FOUR BEND BAY Dimensions in... Millimetres Inches

A - B	B - C <small>(not less than 500mm)</small>	C - D	B - E
D - E <small>(not less than 500mm)</small>	E - F	A - F	

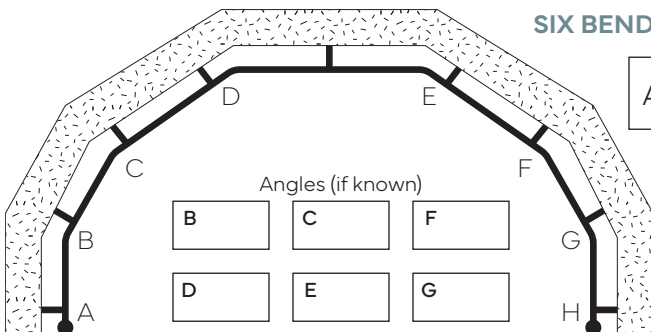

SIX BEND BAY Dimensions in... Millimetres Inches

A - B	B - C <small>(not less than 500mm)</small>	C - D <small>(not less than 500mm)</small>	D - E
E - F <small>(not less than 500mm)</small>	F - G <small>(not less than 500mm)</small>	G - H	
A - H	B - G	C - F	



ROUND38 - WITH RETURNS

Account No.	Account Name:	Contact No.
Town/Branch:	A/C Postcode:	Order Ref.
Track Colour: <input type="radio"/> White <input type="radio"/> Black <input type="radio"/> Chalk <input type="radio"/> Bronze <input type="radio"/> Oyster <input type="radio"/> Ash <input type="radio"/> Nimbus <input type="radio"/> Slate		
Finial Style: <input type="radio"/> End Cap <input type="radio"/> Ball		Bracket Options: <input type="radio"/> Adjustable 75mm-110mm <input type="radio"/> Adjustable 110mm-150mm
Measuring Bay Windows: Identify the type of bay window you have, the measurements as indicated of the actual wall. We will work out the angles and lengths required allowing for bracket standoff etc. (alternatively write in the actual angles on the appropriate diagram if you know them) All tracks are supplied in at least 2 parts and oversized to be trimmed on site.		Return Length: <div style="display: flex; justify-content: space-around; align-items: center;"> <div style="border: 1px solid black; width: 60px; height: 25px; text-align: center; margin: 0 5px;">mm</div> <div style="border: 1px solid black; width: 60px; height: 25px; text-align: center; margin: 0 5px;">inches</div> </div> <p style="font-size: small; margin-top: 5px;">Unless otherwise requested we will return the track no more than 200mm along the wall</p>
Glider Options <input type="radio"/> Standard Gliders <input type="radio"/> Surf 60 - Single Curtain <input type="radio"/> Surf 80 - Single Curtain <input type="radio"/> Surf 60 - Pair of Curtains <input type="radio"/> Surf 80 - Pair of Curtains		

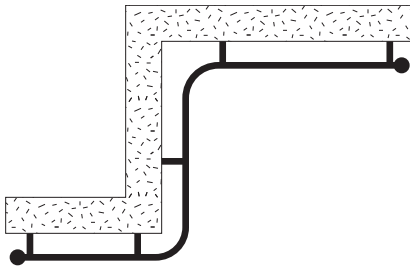

TWO BEND BAY INCLUDING RETURN

Dimensions in... Millimetres Inches

A - B <small>(not less than 500mm)</small>	B - C <small>(not less than 500mm)</small>
Angle Required:	Number of Curtains:

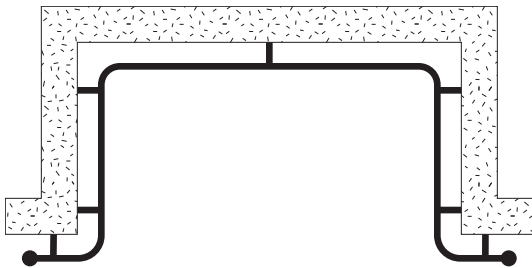

FOUR BEND BAY INCLUDING RETURN

Dimensions in... Millimetres Inches

A - B <small>(not less than 500mm)</small>	B - C
C - D <small>(not less than 500mm)</small>	A - D

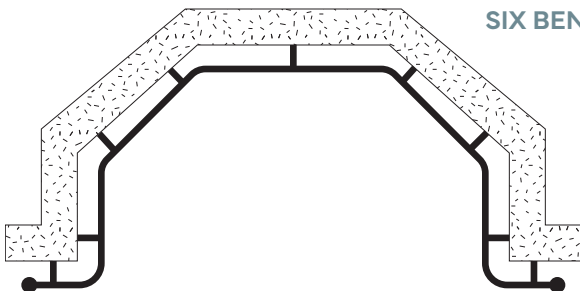

SIX BEND BAY INCLUDING RETURN

Dimensions in... Millimetres Inches

A - B <small>(not less than 500mm)</small>	B - C <small>(not less than 500mm)</small>	C - D	D - E <small>(not less than 500mm)</small>
E - F <small>(not less than 500mm)</small>	F - G	G - H	
A - H	B - G	C - F	

